VISTA-40

2-Partition Security System

Programming Guide

**Single Partition and 2-Partition
Programming Forms**

® ADEMCO

TABLE OF CONTENTS

SINGLE PARTITION PROGRAMMING FORM	3
TWO-PARTITION PROGRAMMING FORM	7
SYSTEM-WIDE DATA FIELDS.....	8
PARTITION-SPECIFIC DATA FIELDS	11
PROGRAMMING WITH #93 MENU MODE (Overview)	13
CHANGING ZONE RESPONSE TYPE & REPORT CODES (EXPERT MODE)	14
SYSTEM LAYOUT WORKSHEETS	16

Other Documents Provided With The VISTA-40

<i>Document</i>	<i>Purpose and Content</i>
Installation Instructions	Use the Installation Instructions portion of this manual when installing the hard-ware components of the installation, including hardwired zones, wireless transmitters, powering the control, etc. Use the Programming Procedures section of the installation manual when programming the system. It provides detailed programming procedures and descriptions of all data fields. It also provides detailed procedures for using #93 Menu Mode. A Summary Of Connections Diagram is provided at the back of the Installation Instructions.
User's Manual	Intended for the end user, this manual provides procedures for system operation.

This Programming Guide includes basic programming information, a brief overview of the programming procedure with #93 Menu Mode, Changing Response type & Report Codes (Expert Mode), Single and 2-Partition Programming Forms, plus System Layout Worksheets.

Two programming forms are provided: A Single Partition Form and a 2-Partition Form.

- Make sure that one alpha or voice/alpha keypad is connected to the control and is set to device address "00."

Single Partition System

- The system default is for a single partition system. Use the SINGLE PARTITION PROGRAMMING FORM beginning on page 4 when programming for single partition usage.

Two-Partition System

- You must enter "2" in data field 2*00 to set the system for two partitions. Use the 2-PARTITION PROGRAMMING FORM beginning on page 8 when programming the system for two partitions.

#93 Menu Mode

- Because the control supports various types of input devices (such as button type transmitters, serial number polling loop devices, etc.), zone characteristics, including zone response types and report codes, must be programmed using the #93 Menu Mode procedure.
- In addition to programming zone information, #93 Menu Mode is required for enrolling serial numbers, programming alpha descriptors, programming device characteristics and for programming relay output functions.
- Refer to the separate Installation and Setup Guide for detailed procedures when using #93 Menu Mode.

VISTA-40 SINGLE PARTITION PROGRAMMING FORM

Use the **Single Partition Programming Form** only if your system is set up as a single partition system.

For 2-partition systems, use the form titled "**VISTA-40 Two-Partition Programming Form.**"

Steps To Programming a Single Partition VISTA-40 System

IMPORTANT: A 2-Line Alpha keypad is required for programming the VISTA-40.

Make sure that one alpha keypad is connected to the control and is set to device address "00."

1. Enter Programming Mode (enter installer code + [8] + [0] + [0]).
2. Program the data fields shown on the programming form.

NOTE: Zone Response Type and Report Code fields will automatically appear during normal programming, but must be skipped if the zone has not been previously programmed using #93 Menu Mode (see step 3 below). These fields are bordered by a dotted line on the programming forms and include:

*02 - *05 and 1*01 - 1*09 ASSIGN RESPONSE TYPES
*54 - *78 REPORT CODES

To skip these fields when they appear, press [*] plus the next data field number to be programmed. For example, to skip fields *02 - *05 in a one partition system, press [*] plus "09." Field *09 ENTRY DELAY #1 appears.

3. Enter #93 Menu Mode by pressing #93 while in programming mode, then do the following in the order presented:
 - Use the DEVICE PROG. prompts to program device addresses and characteristics.
 - Use the ZONE PROG. prompts to program zone information.
 - Use the RELAY PROG. prompts to program relay output information.
 - Use the ALPHA PROG. prompts to program alpha descriptors.
 - Use the SERIAL # PROG prompts to program sensor device serial numbers.
 - Use RLY VOICE DESCR. prompts to program relay voice descriptors, if the 4285 Phone Module is used.
 - Use the CUSTOM INDEX prompts to program custom word substitutes, if the 4285 Phone Module is used.

Refer to the #93 Menu Mode section of the separate INSTALLATION INSTRUCTIONS document for detailed procedures when using #93 Menu Mode. A brief overview of this mode is provided later in this document.

SUMMARY OF PROGRAMMING COMMANDS

- **To enter program mode**, enter installer code + [8] + [0] + [0]
- **To set standard defaults**, press *97
- **To set communication defaults**, press *94 + one of the following: *80=low speed; *81=Ademco Express; *82=Ademco High Speed; *83=Ademco's Contact ID
- **To change to next page of program fields**, press *94
- **To return to previous set of fields**, press *99
- **To erase account & phone number field entries**, press [*] + field number + [*]
- **To assign zone descriptors**, press #93 + follow menu prompts
- **To add custom words**, press #93 + follow menu prompts
- **To enter Installer's Message**, press #93 + follow menu prompts
- **To exit program mode**, press *99 OR *98: *99 allows re-access to programming mode by installer code. *98 prevents re-access to programming mode by installer code.

VISTA-40 SINGLE PARTITION PROGRAMMING FORM

Standard default (*97) values are shown in brackets [], otherwise default = 0.

*00 INSTALLER CODE [4140]
Enter 4 digits, 0-9

*02 - *05 ASSIGN RESPONSE TYPE FOR ZONES
Skip these fields. Use #93 Menu Mode, Zone Programming to program response types.

*09 ENTRY DELAY #1 [02]
(00-15 times 15 seconds)

*10 EXIT DELAY #1 [03]
(00-15 times 15 seconds)

*11 ENTRY DELAY #2 [06]
(00-15 times 15 seconds)

*12 EXIT DELAY #2 [08]
(00-15 times 15 seconds)

*13 ALARM SOUNDER DURATION [04]
01-15 times 2 minutes . Minimum 4 minutes for UL.

*14 ZONE 9 FAST/SLOW RESPONSE
1=fast; 0= slow; "0" for UL.

*15 KEYSWITCH ASSIGNMENT
Enter partition in which keyswitch used, 1-2; 0=disable

*16 CONFIRMATION OF ARMING DING
1=enable; 0=disable

*17 AC LOSS KEYPAD SOUNDING
1=yes; 0=no

*19 RANDOMIZE AC LOSS REPORT
1=randomize 10-40 min.; 0=no

*20 4285 PHONE MODULE ACCESS CODE
Enter 01-09 for 1st digit; 11(for *) or 12 (for #) for 2nd digit To disable voice module, enter 1st digit = 00 & 2nd digit = 11
[00] [11]

*21 PREVENT FIRE TIME-OUT
1=no timeout; 0=fire timeout

*22 KEYPAD PANIC ENABLES [0-0-1]
1=enable; 0=disable
95 96 99

*23 MULTIPLE ALARMS [1]
1=yes; 0=no

*24 IGNORE EXPANSION ZONE (RF, RPM) TAMPER
1=disable; 0=enable

*25 LRR BURG.TRIGGER FOR TYPE 8 [1]
1=enable; 0=disable

*26 INTELLIGENT TEST REPORTING
Set "0" for UL 1=yes, (no report sent if any other report was recently sent); 0=no

*27 TEST REPORT INTERVAL [024]
Enter interval in hours, 001-199; 000=no report ; Max. 024 for UL.

*28 POWER UP IN PREVIOUS STATE [1]
1=yes; 0=no; "1" for UL.

*29 QUICK ARM [1]
1=yes; 0=no

*30 TOUCH-TONE OR ROTARY DIAL
1=TouchTone; 0=rotary

*31 PABX ACCESS CODE
00-09; B-F (11-15)

*32 PRIM. SUBS. ACCT #
Enter 00-09; B-F (11-15) [15 15 15 15]

*33 PRIMARY PHONE NUMBER

Enter 0-9 for each digit, or #11 (*), #12 (#), #13 (pause)

*34 SECONDARY PHONE NUMBER

Enter 0-9 for each digit, or #11 (*), #12 (#), #13 (pause)

*35 DOWNLOAD PHONE No.

Enter 0-9 for each digit, or #11 (*), #12 (#), #13 (pause)

*36 DOWNLOAD ID No.

Enter 00-09; A-F (10-15) [15 15 15 15 15 15 15]

*37 DOWNLOAD COMMAND ENABLES
 0
Dialer System Not Remote Remote Remote Upload Download
Shutdwn Shutdwn Used Bypass Disarm Arm Program Program
See field 1*53 for Callback disable option; [1=enable]; 0=disable; For UL installations, all options must be disabled.

*38 PREVENT ZONE XX BYPASS
01-64; 00 if all zones (except Fire zones) can be bypassed

*39 OPEN/CLOSE REPORT FOR INSTALLER
1=enable; 0=disable

*40 OPEN/CLOSE REPORTING FOR KEYSWITCH
1=enable; 0=disable

*41 NORMALLY CLOSED or EOLR (Zones 2-8) [1]
1=N.C.loops; 0=EOLR supervision; Must be "0" for UL.

*42 DIAL TONE PAUSE
0=5 seconds; 1=11 seconds; 2=30 seconds; Must be "0" for UL.

*43 DIAL TONE DETECTION [1]
1=wait for true dial tone; 0=pause, then dial

*44 RING DETECTION COUNT
01-14; 15=answering machine; 00=no detection; Do not set to 00 if voice module is used, or 01 if VIM module is used.

*45 PRIMARY FORMAT
0=Low Speed; 1=Contact ID; 2=Ademco High Speed; 3=Ademco Express

*46 LOW SPEED FORMAT (Primary)
0=Ademco Low Speed; 1=Sescoa/Radionics

*47 SECONDARY FORMAT
0=Low Speed; 1=Contact ID; 2=Ademco High Speed; 3=Ademco Express

*48 LOW SPEED FORMAT (Sec.)
0=Ademco Low Speed; 1=Sescoa/Radionics

*49 CHECKSUM VERIFICATION 1=yes; 0=no
Prim Scndry

*50 SESCOA/RADIONICS SELECT
1=Sescoa; 0=Radionics

*51 DUAL REPORTING
1=yes; 0=no; If used with Split Reporting "1" option (1*34), alarms go to both primary & secondary numbers, while all other reports go to secondary only. If used with Split Reporting "2" option, open/close and test messages go to both lines, while all other reports go to primary.

*52 STANDARD/EXPANDED REPORT FOR PRIMARY

Alarm Rstr Bypass Trbl Opn/Cls Low Bat
0=standard; 1=expanded; Note: Expanded overrides 4+2 format.

*53 STANDARD/EXPANDED REPORT FOR SECONDARY

Alarm Rstr Bypass Trbl Opn/Cls Low Bat
0=Standard; 1=Expanded; Note: Expanded Overrides 4+2 Format.

VISTA-40 SINGLE PARTITION PROGRAMMING FORM

***54 - *57 ALARM REPORT CODE & ID DIGITS FOR ZONES 1-16.** Skip these fields. Use #93 Menu Mode, Zone Programming to assign report codes.

***58 SUPV. & RESTORE CODES for zones 1-16**

<input type="text"/>	Alarm Rst.
<input type="text"/>	Trouble
<input type="text"/>	Trble Rst.
<input type="text"/>	Bypass
<input type="text"/>	Bypass Rst.

***59 - *62 ALARM REPORT CODE & ID DIGITS FOR ZONES 17-32.** Skip these fields. Use #93 Menu Mode, Zone Programming to assign report codes.

***63 SUPV. & RESTORE CODES for zones 17-32**

<input type="text"/>	Alarm Rst.
<input type="text"/>	Trouble
<input type="text"/>	Trble Rst.
<input type="text"/>	Bypass
<input type="text"/>	Bypass Rst.

***64 - *67 ALARM REPORT CODE & ID DIGITS FOR ZONES 33-48.** Skip these fields. Use #93 Menu Mode, Zone Programming to assign report codes.

***68 SUPV. & RESTORE CODES for zones 33-48**

<input type="text"/>	Alarm Rst.
<input type="text"/>	Trouble
<input type="text"/>	Trble Rst.
<input type="text"/>	Bypass
<input type="text"/>	Bypass Rst.

***69 - *72, ALARM REPORT CODE & ID DIGITS FOR ZONES 49-64**
***74 - *77** 49-99. Skip these fields. Use #93 Menu Mode, Zone Programming to assign report codes.

SUPV. & RESTORE CODES

***73 (for zones 49-64) *78 (for zones 87-99)**

<input type="text"/>	Alarm Rst.	<input type="text"/>	Alarm Rst.
<input type="text"/>	Trouble	<input type="text"/>	Trouble
<input type="text"/>	Trble Rst.	<input type="text"/>	Trble Rst.
<input type="text"/>	Bypass	<input type="text"/>	Bypass
<input type="text"/>	Bypass Rst.	<input type="text"/>	Bypass Rst.

ZONE TYPE RESTORE ENABLES 1=enable; [0]=disable

***79 FOR ZONE TYPES 1-8 *80 ZONE TYPES 9/10**

<input type="text"/>	<input type="text"/>	<input type="text"/>	<input type="text"/>	<input type="text"/>	<input type="text"/>	<input type="text"/>	<input type="text"/>	<input type="text"/>	<input type="text"/>
1	2	3	4	5	6	7	8	9	10

SYSTEM NON ALARM CODES

	*81	*82
	First Digit	Second Digit
Close	<input type="text"/>	<input type="text"/>
Open	<input type="text"/>	<input type="text"/>
Low Battery	<input type="text"/>	<input type="text"/>
Low Bat Res	<input type="text"/>	<input type="text"/>
AC Loss	<input type="text"/>	<input type="text"/>
AC Restore	<input type="text"/>	<input type="text"/>
Test	<input type="text"/>	<input type="text"/>
Power	<input type="text"/>	<input type="text"/>
Cancel	<input type="text"/>	<input type="text"/>
Prog. Tamp.	<input type="text"/>	<input type="text"/>

Second digit of each code applies only to 4+2 or expanded (fields *52 & *53) formats.

***83 FIRST TEST REPORT TIME**
 [Day 00; hour 12; min 00] Days 01-07 Hours 00-23 Min 00-59;
 00 in all boxes=instant (Day 01= Monday)

***84 SWINGER SUPPRESSION** [03]
 01-15 alarms ; Must be "00" (disabled) for UL.

***85 ENABLE DIALER REPORTS**
FOR PANICS & DURESS 95 96 99 Duress
 1=enable; 0=disable

***86 4208 MODULE ZONE ASSIGNMENT**
 1=allows 8 zone numbers (10-17) on one module, but prevents any other polling loop expansion; 0=Otherwise

***87 ENTRY WARNING** [1]
 1=continuous; 0=3 beeps

***88 BURG. ALARM COMM. DELAY**
 1=16 seconds; 0=no delay

***89 RESTORE REPORT TIMING**
 0=instant; 1=at bell timeout; 2=at disarm

***90 2nd SUBS. ACCT #**
 Enter 00-09; B-F (11-15) [15 15 15 15]

2nd Page Programming Fields (press *94)

1*01 - 1*09 ASSIGN RESPONSE TYPE FOR ZONES
 Skip these fields. Use #93 Menu Mode, Zone Programming to assign response types

1*28 RF TX LOW BATTERY SOUND
 1=immediate; 0=when disarmed; Must be "1" for UL

1*29 RF TX LOW BATTERY REPORT ENABLE
 1=enable; 0=disable Must be "1" for UL

1*30 RF RCVR CHECK-IN INTERVAL [06]
 02-15 times 2 hours; 00 disables supervision
 Max. "6" (12 hr) for UL

1*31 RF TRANSMITTER CHECK-IN INTERVAL[12]
 02-15 times 2 hours; 00 disables transmitter supervision
 Max. "6" (12 hr) for UL

1*32 RF RECEIVER TYPE
 1=4281 ; 2=5881; 0=NONE

1*33 TOUCH-TONE W/ROTARY BACKUP ENABLE
 1=enable; 0=disable

VISTA-40 TWO-PARTITION PROGRAMMING FORM

Use the Two-Partition Programming Form if your system is set up for two partitions.

For single partition systems, use the form titled "VISTA-40 Single Programming Form."

IMPORTANT: A 2-Line Alpha keypad is required for programming the VISTA-40.

Make sure that one alpha keypad is connected to the control and is set to device address "00."

1. Enter Programming Mode (enter **installer code** + [8] + [0] + [0]).
2. Go to field 2*00 and enter "2" to set the system for two partitions.

When set for two partitions, there are some data fields that are system-wide (global) and some that are "partition-specific." The partition-specific fields, shown shaded on the form, can be assigned different values for each partition, and these fields are automatically skipped when programming system-wide fields. To program partition-specific fields, see step 4 below.

3. Program the system-wide (global) data fields shown on the main portion of the programming form. These include all fields except those shown shaded and Zone Response Type and Report Code fields, which require using #93 Menu Mode to program (see step 5 below).

NOTE: zone response Type and Report Code fields will automatically appear during normal programming, but must be skipped if the zone has not been previously programmed using #93 Menu Mode (see step 5 below). These fields are bordered by a dotted line on the programming forms and include:

*02→*05 and 1*01–1*09 ASSIGN RESPONSE TYPES
*54→*78 REPORT CODES

To skip these fields when they appear, press [*] plus the next data field number to be programmed. For example, to skip fields *02→*05, press [*] plus "14." Field *14 ZONE 9 FAST/SLOW RESPONSE appears.

4. Program the partition-specific data fields by pressing *91 and entering the partition number you wish to program. The first partition-specific field (*09 ENTRY DELAY #1) for that partition automatically appears. Refer to the Partition-Specific section of this programming form when programming these fields for each partition.
5. Enter #93 Menu Mode by pressing #93 while in programming mode, then do the following in the order presented:
 - Use the DEVICE PROG. prompts to program device addresses and characteristics.
 - Use the ZONE PROG. prompts to program zone information.
 - Use the RELAY PROG. prompts to program relay output information.
 - Use the ALPHA PROG. prompts to program alpha descriptors.
 - Use the SERIAL # PROG prompts to program sensor device serial numbers.
 - Use RLY VOICE DESCR. prompts to program relay voice descriptors, if the 4285 Phone Module is used.
 - Use the CUSTOM INDEX prompts to program custom word substitutes, if the 4285 Phone Module is used.

Refer to the #93 Menu Mode section of the separate INSTALLATION INSTRUCTIONS document for detailed procedures when using #93 Menu Mode. A brief overview of this mode is provided later in this document.

SUMMARY OF PROGRAMMING COMMANDS

- **To enter program mode**, enter installer code + [8] + [0] + [0]
- **To set standard defaults**, press *97
- **To set communication defaults**, press *94 + one of the following: *80=low speed; *81=Ademco Express; *82=Ademco High Speed; *83=Ademco's Contact ID
- **To change to next page of program fields**, press *94
- **To return to previous set of fields**, press *99
- **To erase account & phone number field entries**, press [*] + field number + [*]
- **To assign zone descriptors**, press #93 + follow menu prompts
- **To add custom words**, press #93 + follow menu prompts
- **To enter Installer's Message**, press #93 + follow menu prompts
- **To exit program mode**, press *99 OR *98: *99 allows re-access to programming mode by installer code. *98 prevents re-access to programming mode by installer code.

Standard default (*97) values are shown in brackets [], otherwise default = 0.

VISTA-40 TWO-PARTITION PROGRAMMING FORM

***00** INSTALLER CODE [4140]
Enter 4 digits, 0-9

***02 - *05** ASSIGN RESPONSE TYPE FOR ZONES
Skip these fields. Use #93 Menu Mode, Zone Programming to program response types.

Refer to the Partition-Specific section of this form for programming shaded fields.

***09** ENTRY DELAY #1 Partition-Specific
***10** EXIT DELAY #1 Partition-Specific
***11** ENTRY DELAY #2 Partition-Specific
***12** EXIT DELAY #2 Partition-Specific
***13** ALARM SOUNDER DURATION Partition-Specific

***14** ZONE 9 FAST/SLOW RESPONSE
1=fast; 0= slow; "0" for UL.

***15** KEYSWITCH ASSIGNMENT
Enter partition in which keyswitch used, 1-2; 0=disable

***16** CONFIRMATION OF ARMING DING Partition-Specific

***17** AC LOSS KEYPAD SOUNDING
1=yes; 0=no

***19** RANDOMIZE AC LOSS REPORT
1=randomize 10-40 min.; 0=no

***20** 4285 PHONE MODULE ACCESS CODE
Enter 01-09 for 1st digit; 11(for *) or 12 (for #) for 2nd digit To disable voice module, enter 1st digit = 00 & 2nd digit = 11

***21** PREVENT FIRE TIME-OUT
1=no timeout; 0=fire timeout

***22** KEYPAD PANIC ENABLES Partition-Specific

***23** MULTIPLE ALARMS Partition-Specific

***24** IGNORE EXPANSION ZONE (RF, RPM) TAMPER
1=disable; 0=enable

***25** LRR BURG.TRIGGER FOR TYPE 8 [1]
1=enable; 0=disable

***26** INTELLIGENT TEST REPORTING
Set "0" for UL 1=yes, (no report sent if any other report was recently sent); 0=no

***27** TEST REPORT INTERVAL [024]
Enter interval in hours, 001-199; 000=no report ; Max. 024 for UL.

***28** POWER UP IN PREVIOUS STATE [1]
1=yes; 0=no; "1" for UL.

***29** QUICK ARM Partition-Specific

***30** TOUCH-TONE OR ROTARY DIAL
1=TouchTone; 0=rotary

***31** PABX ACCESS CODE
00-09; B-F (11-15)

***32** PRIM. SUBS. ACCT # Partition-Specific

***33** PRIMARY PHONE NUMBER
Enter 0-9 for each digit, or #11 (*), #12 (#), #13 (pause)

***34** SECONDARY PHONE NUMBER
Enter 0-9 for each digit, or #11 (*), #12 (#), #13 (pause)

***35** DOWNLOAD PHONE No.
Enter 0-9 for each digit, or #11 (*), #12 (#), #13 (pause)

***36** DOWNLOAD ID No.
Enter 00-09; A-F (10-15) [15 15 15 15 15 15 15]

***37** DOWNLOAD COMMAND ENABLES

 Dialer System Not Remote Remote Remote Upload Download
 Shutdwn Shutdwn Used Bypass Disarm Arm Program Program
 See field 1*53 for Callback disable option; [1=enable]; 0=disable; For UL installations, all options must be disabled.

***38** PREVENT ZONE XX BYPASS Partition-Specific

***39** OPEN/CLOSE FOR INSTALLER Partition-Specific

***40** OPEN/CLOSE REPORTING FOR KEYSWITCH
1=enable; 0=disable

***41** NORMALLY CLOSED or EOLR (Zones 2-8) [1]
1=N.C.loops; 0=EOLR supervision; Must be "0" for UL.

***42** DIAL TONE PAUSE
0=5 seconds; 1=11 seconds; 2=30 seconds; Must be "0" for UL.

***43** DIAL TONE DETECTION [1]
1=wait for true dial tone; 0=pause, then dial

***44** RING DETECTION COUNT
01-14; 15=answering machine; 00=no detection; Do not set to "00" if voice module is used, or "01" if VIM is used.

***45** PRIMARY FORMAT
0=Low Speed; 1=Contact ID; 2=Ademco High Speed; 3=Ademco Express

***46** LOW SPEED FORMAT (Primary)
0=Ademco Low Speed; 1=Sescoa/Radionics

***47** SECONDARY FORMAT
0=Low Speed; 1=Contact ID; 2=Ademco High Speed; 3=Ademco Express

***48** LOW SPEED FORMAT (Sec.)
0=Ademco Low Speed; 1=Sescoa/Radionics

***49** CHECKSUM VERIFICATION
1=yes; 0=no Prim Scndry

***50** SESCOA/RADIONICS SELECT
1=Sescoa; 0=Radionics

***51** DUAL REPORTING
1=yes; 0=no; If used with Split Reporting "1" option (1*34), alarms go to both primary & secondary numbers, while all other reports go to secondary only. If used with Split Reporting "2" option, open/close and test messages go to both lines, while all other reports go to primary.

***52** STANDARD/EXPANDED REPORT FOR PRIMARY
Alarm Rstr Bypass Trbl Opn/Cls Low Bat
0=standard; 1=expanded; Note: Expanded overrides 4+2 format.

***53** STANDARD/EXPANDED REPORT FOR SECONDARY
Alarm Rstr Bypass Trbl Opn/Cls Low Bat
0=standard; 1=expanded; Note: Expanded overrides 4+2 format.

***54-*57, *59-*62, *64-*67, *69-*72, *74-*77**
ALARM REPORT CODE & ID DIGITS FOR ZONES
Skip these fields. Use #93 Menu Mode, Zone Programming to assign report codes.

SUPV. & RESTORE CODES

*58 (zones 1-16)	*63 (zones 17-32)	*68 (zones 33-48)	*73 (zones 49-64)
<input type="text"/> <input type="text"/> Alrm Rst.	<input type="text"/> <input type="text"/> Alrm Rst.	<input type="text"/> <input type="text"/> Alrm Rst.	<input type="text"/> <input type="text"/> Alrm Rst.
<input type="text"/> <input type="text"/> Trouble	<input type="text"/> <input type="text"/> Trouble	<input type="text"/> <input type="text"/> Trouble	<input type="text"/> <input type="text"/> Trouble
<input type="text"/> <input type="text"/> Trble Rst.	<input type="text"/> <input type="text"/> Trble Rst.	<input type="text"/> <input type="text"/> Trble Rst.	<input type="text"/> <input type="text"/> Trble Rst.
<input type="text"/> <input type="text"/> Bypass	<input type="text"/> <input type="text"/> Bypass	<input type="text"/> <input type="text"/> Bypass	<input type="text"/> <input type="text"/> Bypass
<input type="text"/> <input type="text"/> Byps Rst.	<input type="text"/> <input type="text"/> Byps Rst.	<input type="text"/> <input type="text"/> Byps Rst.	<input type="text"/> <input type="text"/> Byps Rst.

VISTA-40 TWO-PARTITION PROGRAMMING FORM

SUPV. & RESTORE CODES

*78 (zones 87-99)

Alarm Rst.

Trouble

Trble Rst.

Bypass

Bypass Rst.

ZONE TYPE RESTORE ENABLES 1=enable; 0=disable

*79 FOR ZONE TYPES 1-8

*80 FOR TYPES 9-10

SYSTEM NON ALARM CODES

*81 *82

First Digit Second Digit

Close

Open

Low Battery

Low Bat Res

AC Loss

AC Restore

Test

Power

Cancel

Prog. Tamp.

Second digit of each code applies only to 4+2 or expanded (fields *52 & *53) formats.

*83 FIRST TEST REPORT TIME
 [Day 00: hour 12; min 00] Days 01-07 Hours 00-23 Min 00-59;
 00 in all boxes=instant (Day 01= Monday)

*84 SWINGER SUPPRESSION Partition-Specific

*85 ENABLE DIALER REPORTS FOR PANICS & DURESS Partition-Specific

*86 4208 MODULE ZONE ASSIGNMENT
 1=allows 8 zone numbers (10-17) on one module, but prevents any other polling loop expansion 0=Otherwise

*87 ENTRY WARNING Partition-Specific

*88 BURG. ALARM COMM. DELAY Partition-Specific

*89 RESTORE REPORT TIMING
 0=instant; 1=at bell timeout; 2=at disarm

*90 2nd SUBS. ACCT # Partition-Specific

2nd Page Programming Fields (press *94)

1*01 - 1*09 ASSIGN RESPONSE TYPE FOR ZONES
 Skip these fields. Use #93 Menu Mode, Zone Programming to assign response types

MISCELLANEOUS WIRELESS OPTIONS

1*28 RF TX LOW BATTERY SOUND
 1=immediate; 0=when disarmed; Must be "1" for UL

1*29 RF TX LOW BATTERY REPORT ENABLE
 1=enable; 0=disable
 Must be "1" for UL

1*30 RF RCVR CHECK-IN INTERVAL [06]
 02-15 times 2 hours; 00 disables supervision
 Max. "6" (12 hr) for UL

1*31 RF TRANSMITTER CHECK-IN INTERVAL[12]
 02-15 times 2 hours; 00 disables transmitter supervision
 Max. "6" (12 hr) for UL

1*32 RF RECEIVER TYPE
 1=4281; 2=5881; 0=NONE

1*33 TOUCH-TONE W/ROTARY BACKUP ENABLE
 1=enable; 0=disable

1*34 COMM. SPLIT REPORT SELECTION
 0=no; 1=alarms primary, others secondary;
 2=open/close, test secondary, others primary; See *51 for comments.

DIALER CODES (Armed Stay, Time Set & Event Logging)

1*40 1*41
 First Digit Second Digit

Armed STAY

Time/Date set or event log reset

1*43 PERM. KEYPAD BACKLIGHT Partition-Specific

1*44 WIRELESS KEYPAD TAMPER DETECT ENABLE
 1=enable; 0=disable

1*45 EXIT DELAY SOUNDING Partition-Specific

1*46 AUXILIARY OUTPUT MODE
 0=ground start; 1=open/close trigger; 2=keypad sounding
 3=Non-Ademco AAV unit trigger

1*47 CHIME ON EXT SIREN Partition-Specific

1*48 WIRELESS KEYPAD ASSIGNMENT
 0=disable; enter partition in which RF keypad used, 1-2.

1*49 SUPPRESS TX SUPERVISION SOUND [1]
 1=disable; 0=enable. Must be "0" for UL.

1*52 SEND CANCEL IF ALARM + OFF Partition-Specific

1*53 DOWNLOAD CALLBACK
 1=callback not required; 0=callback required; Must be "0" for UL.

1*57 ENABLE 5800 RF BUTTON GLOBAL ARM
 Enter "1" to have the system arm/disarm following the button's user's global arm settings. Enter "0" if the button is not to be used to global arm the system.

1*58 ENABLE 5800 RF BUTTON FORCE BYPASS
 If zone is faulted after pressing button, keypad will beep once. User should press button again within 4 sec. to force bypass those zones. Enter 1 if force bypass is desired. Enter 0 if not desired.

1*60 AAV MODULE SELECT
 Enter "1" only if AAV unit is used.
 NOTE: If enabled zone 5 can no longer be used as a protection zone.

1*70 EVENT LOG TYPES
 1=enable logging; 0=disable Alrm Chck Byp O/C System

1*71 12/24 HOUR TIME STAMP FORMAT
 0=12 hour; 1=24 hour

1*74 RELAY TIMEOUT XX MINUTES
 Enter the relay timeout, 0-127 in multiples of 2 minutes, desired for #93 Menu Mode Relay Programming output command "56".

1*75 RELAY TIMEOUT YY SECONDS
 Enter the relay timeout, 0-127 seconds, desired for #93 Menu Mode Relay Programming command "57".

1*76 ACCESS CONTROL Partition-Specific

VISTA-40 TWO-PARTITION PROGRAMMING FORM

3rd Page Programming Fields (press *94)

2*00 NUMBER OF PARTITIONS [1]
Enter 2 for two partition systems.

2*01 DAYLIGHT SAVINGS TIME |
START/END MONTH Start End
00-12; if no daylight savings time, enter 00,00; default=04,10]

2*02 DAYLIGHT SAVINGS TIME |
START/END WEEKEND # Start | End
Enter 1-7. 1=first; 2=second; 3=third; 4=fourth; 5=last; 6=next to last; 7=3rd from last [1,5; 1st Sunday in April, last in Oct.]

2*17 NUMBER OF CODES PER PARTITION 1 |
Enter 01-69. Total must be less than or equal to 70. 2 |
[Default=69 in part. 1; 01 in partition 2]

2*18 ENABLE GOTO FOR THIS PARTITION Partition-Specific

2*19 USE PARTITION DESCRIPTORS
0=disable; 1=enable

2*20 ENABLE J7 TRIGGERS BY PARTITION Partition-Specific

2*21 ENABLE SUPERVISION PULSES FOR LRR TRIGGER OUTPUTS | |
Used for supervised connection to 7920SE.
Enter 0 to disable or 1 to enable the listed outputs.
F= Fire; B= Burglary; S= Silent panic/duress

VISTA-40 TWO-PARTITION PROGRAMMING FORM

PARTITION-SPECIFIC FIELDS (PARTITION #1)

To program these fields,

1. Press *91 to select a partition.
2. Enter a partition-specific field number (ex. *09).
3. Repeat steps 1 & 2 for each partition in the system.
4. To return to the global program fields, enter a global field number.

PARTITION # 1 PROGRAM FIELDS

1st Page Fields

- *09 ENTRY DELAY #1 [02] |
 (00-15 times 15 seconds)
- *10 EXIT DELAY #1 [03] |
 (00-15 times 15 seconds)
- *11 ENTRY DELAY #2 [06] |
 (00-15 times 15 seconds)
- *12 EXIT DELAY #2 [08] |
 (00-15 times 15 seconds)
- *13 ALARM SOUNDER DURATION [04] |
 01-15 times 2 minutes. Minimum 4 minutes for UL.
- *16 CONFIRMATION OF ARMING DING
 1=enable; 0=disable
- *22 KEYPAD PANIC ENABLES [0-0-1]
 1=enable; 0=disable 95 96 99
- *23 MULTIPLE ALARMS [1]
 1=yes; 0=no
- *29 QUICK ARM [1]
 1=yes; 0=no
- *32 PRIMARY SUBSCRIBER ACCT #
 | | |
 Enter 00-09; B-F (11-15) [15 15 15 15]
- *38 PREVENT ZONE XX BYPASS |
 01-64; 00 if all zones (except Fire zones) can be bypassed
- *39 ENABLE OPEN/CLOSE REPORT
 FOR INSTALLER CODE 1=enable; 0=disable
- *84 SWINGER SUPPRESSION [03] |
 01-15 alarms; Must be "00" (disabled) for UL.
- *85 ENABLE DIALER REPORTS
 FOR PANICS & DURESS 95 96 99 Duress
 1=enable; 0=disable
- *87 ENTRY WARNING [1]
 1=continuous; 0=3 beeps
- *88 BURG. ALARM COMM. DELAY
 1=16 seconds; 0=no delay
- *90 SECONDARY SUBSCRIBER ACCT #
 | | |
 Enter 00-09; B-F (11-15) [15 15 15 15]

2nd Page Fields

- 1*43 PERM. KEYPAD BACKLIGHT
 1=enable; 0=disable; When disabled, display lights when any key is pressed, and turns off after period of keypad inactivity.
- 1*45 EXIT DELAY SOUNDING
 1=enable; 0=disable; Produces quick beeping during exit delay if enabled.
- 1*47 CHIME ON EXT SIREN
 1=enable; 0=disable
- 1*52 SEND CANCEL IF ALARM + OFF
 1=no restriction; 0=within Bell Timeout period only
- 1*76 ACCESS CONTROL RELAY FOR PARTITION |
 Enter relay number that will be pulsed for 2 seconds whenever code + [0] is pressed. Enter 00-08 00=none

3rd Page Fields

- 2*18 ENABLE GOTO FOR THIS PARTITION
 1=enable; 0=disable
- 2*20 ENABLE J7 TRIGGERS by PARTITION [1]
 0=disable for displayed partition; 1=enable for displayed partition

VISTA-40 TWO-PARTITION PROGRAMMING FORM

PARTITION-SPECIFIC FIELDS (PARTITION #2)

To program these fields,

1. Press *91 to select a partition.
2. Enter a partition-specific field number (ex. *09).
3. Repeat steps 1 & 2 for each partition in the system.
4. To return to the global program fields, enter a global field number.

PARTITION # 2 PROGRAM FIELDS

1st Page Fields

- *09 ENTRY DELAY #1 [02]
(00-15 times 15 seconds)
- *10 EXIT DELAY #1 [03]
(00-15 times 15 seconds)
- *11 ENTRY DELAY #2 [06]
(00-15 times 15 seconds)
- *12 EXIT DELAY #2 [08]
(00-15 times 15 seconds)
- *13 ALARM SOUNDER DURATION [04]
01-15 times 2 minutes. Minimum 4 minutes for UL.
- *16 CONFIRMATION OF ARMING DING
1=enable; 0=disable
- *22 KEYPAD PANIC ENABLES [0-0-1]
1=enable; 0=disable 95 96 99
- *23 MULTIPLE ALARMS [1]
1=yes; 0=no
- *29 QUICK ARM [1]
1=yes; 0=no
- *32 PRIMARY SUBSCRIBER ACCT #

Enter 00-09; B-F (11-15) [15 15 15 15]
- *38 PREVENT ZONE XX BYPASS
01-64; 00 if all zones (except Fire zones) can be bypassed
- *39 ENABLE OPEN/CLOSE REPORT FOR INSTALLER CODE
1=enable; 0=disable
- *84 SWINGER SUPPRESSION [03]
01-15 alarms [15]; Must be "00" (disabled) for UL.
- *85 ENABLE DIALER REPORTS FOR PANICS & DURESS
1=enable; 0=disable 95 96 99 Duress
- *87 ENTRY WARNING [1]
1=continuous; 0=3 beeps
- *88 BURGLAR ALARM COMM. DELAY
1=16 seconds; 0=no delay
- *90 SECONDARY SUBSCRIBER ACCT #

Enter 00-09; B-F (11-15) [15 15 15 15]

2nd Page Fields

- 1*43 PERM. KEYPAD BACKLIGHT
1=enable; 0=disable; When disabled, display lights when any key is pressed, and turns off after period of keypad inactivity.
- 1*45 EXIT DELAY SOUNDING
1=enable; 0=disable; Produces quick beeping during exit delay if enabled.
- 1*47 CHIME ON EXT SIREN
1=enable; 0=disable
- 1*52 SEND CANCEL IF ALARM + OFF
1=no restriction; 0=within Bell Timeout period only
- 1*76 ACCESS CONTROL RELAY FOR PARTITION
Enter relay number that will be pulsed for 2 seconds whenever code + [0] is pressed. Enter 00-08 00=none

3rd Page Fields

- 2*18 ENABLE GOTO FOR THIS PARTITION
1=enable; 0=disable
- 2*20 ENABLE J7 TRIGGERS by PARTITION [1]
0=disable for displayed partition; 1=enable for displayed partition

PROGRAMMING WITH #93 MENU MODE (Overview*)

NOTE: The following fields should be preset before beginning: 2*00 Number of Partitions; 1*32 Receiver Type. In addition, receivers should be programmed via Device programming.

* Refer to the #93 Menu Mode section of the separate INSTALLATION INSTRUCTIONS document for detailed programming procedures with this mode.

After programming all system related programming fields in the usual way, press #93 while still in programming mode to display the first choice of the menu driven programming functions. Press 0 (NO) or 1 (YES) in response to the displayed menu selection. Pressing 0 will display the next choice in sequence. Menu selections are as follows:

ZONE PROG? 0=No 1=Yes

- For programming the following:
- Zone Number
 - Zone Response Type
 - Hardwired zone
 - Wireless Zone (type RF, UR or BR)
 - Right/left Loop Zone
 - Serial number RPM zone
 - Partition Number for Zone
 - Dialer report code for zone

SEQUENTIAL LEARN 0=no 1=yes
--

For entering (enrolling) 5800 transmitter & serial number polling loop device serial numbers into the system.

ALPHA PROG? 0=no 1=yes

- For entering alpha descriptors for the following:
- Zone Descriptors
 - Installer's Message
 - Custom Words
 - Partition Descriptors
 - Relay Descriptors

DEVICE PROG? 0=no 1=yes

- For defining the following device characteristics for addressable devices, including keypads, RF receivers (4281/5881) and 4204 output relay modules:
- Device Address
 - Device Type
 - Device's Home Partition
 - Keypad Options
 - FA4285/4286Phone Module

RELAY PROG? 0=no 1=yes

For defining output relay functions.

RLY VOICE DESCR? 0=no 1=yes
--

For entering voice descriptors to be used with voice module functions.

CUSTOM INDEX #? 0=no 1=yes

For creating custom word substitutes for voice module annunciation.

CLEAR RF SERIAL#? 0=no 1=yes

For deleting all RF serial numbers presently enrolled in the system.

#93 MENU MODE KEY COMMANDS

The following is a list of commands used while in the menu mode.

#93	Enters Menu mode
[*]	Serves as ENTER key. Press to have keypad accept entry.
[#]	Backs up to previous screen.
0	Press to answer NO
1	Press to answer YES
01-99	All data entries are 2-digit entries.
00	Escapes from menu mode, back into field programming mode.

CHANGING ZONE RESPONSE TYPE AND REPORT CODE DATA FIELDS (Expert Mode)

- Because the VISTA-40 supports various types of input devices (such as button type transmitters, serial number polling loop devices, etc.), zone characteristics, including zone response types and report codes, must be initially programmed using #93 Menu Mode. However, once a zone has been programmed, changes in response type or report code can be made using the respective data fields. This section lists these fields.
- Zone Response Type and Report Code fields will automatically appear during normal programming, but must be skipped if the zone has not been previously programmed. These fields include:

*02 - *05 and 1*01 - 1*09 ASSIGN RESPONSE TYPES
*54 - *78 REPORT CODES

To program these fields:

1. Enter Program Mode (enter installer code + [8] + [0] + [0]).
2. Press [*] followed by the data field you wish to program.
3. Refer to the following list of fields when programming Zone Response Types and/or Report Codes.
4. Press *99 to exit program mode when programming is complete.

ZONE RESPONSE TYPE FIELDS

Response Types:

00 = Disabled zone
01 = Entry/Exit #1
02 = Entry/Exit #2
03 = Perimeter
04 = Interior Follower
05 = Day/Night
06 = 24 hour Silent Alarm
07 = 24 hour Audible Alarm

08 = 24 hour Auxiliary
09 = Fire
10 = Interior, Delay
20 = Arm stay
21 = Arm away
22 = Disarm
23 = No alarm response

Notes:

Use of 1 or 2 RF RCVRs requires enabling their respective faults (88-91) as troubles (type 5).
Enter 00 if no annunciation is desired.
88 & 90 = RCVR not receiving transmitter signals.
89 & 91 = RCVR not responding, bad conn. to panel.
87 = voice module supervision (type 05)
98 = Bell supervision (type 05)

*02 - *05 ASSIGN RESPONSE TYPE FOR ZONES 1-27
(Enter 00-10; see Response Types below) see fields 1*01-1*09 to program response types for zones 28-87.

*02	*03	*04	*05
1 <input type="text"/> [9]	9 <input type="text"/>	17 <input type="text"/>	25 <input type="text"/>
2 <input type="text"/> [3]	10 <input type="text"/>	18 <input type="text"/>	26 <input type="text"/>
3 <input type="text"/> [3]	11 <input type="text"/>	19 <input type="text"/>	27 <input type="text"/>
4 <input type="text"/> [3]	12 <input type="text"/>	20 <input type="text"/>	0 0
5 <input type="text"/> [3]	13 <input type="text"/>	21 <input type="text"/>	97 <input type="text"/> poll loop short
6 <input type="text"/> [3]	14 <input type="text"/>	22 <input type="text"/>	95 <input type="text"/> (1+* or A panic)
7 <input type="text"/> [3]	15 <input type="text"/>	23 <input type="text"/>	96 <input type="text"/> (3+ # or C panic)
8 <input type="text"/> [3]	16 <input type="text"/>	24 <input type="text"/>	99 <input type="text"/> (* + # or B panic)

ASSIGN RESPONSE TYPE FOR ZONES
(Enter 00-10; see Response Types below)

1*01	1*02	1*03	1*04	1*05
28 <input type="text"/>	33 <input type="text"/>	41 <input type="text"/>	49 <input type="text"/>	57 <input type="text"/>
29 <input type="text"/>	34 <input type="text"/>	42 <input type="text"/>	50 <input type="text"/>	58 <input type="text"/>
30 <input type="text"/>	35 <input type="text"/>	43 <input type="text"/>	51 <input type="text"/>	59 <input type="text"/>
31 <input type="text"/>	36 <input type="text"/>	44 <input type="text"/>	52 <input type="text"/>	60 <input type="text"/>
32 <input type="text"/>	37 <input type="text"/>	45 <input type="text"/>	53 <input type="text"/>	61 <input type="text"/>
	38 <input type="text"/>	46 <input type="text"/>	54 <input type="text"/>	62 <input type="text"/>
	39 <input type="text"/>	47 <input type="text"/>	55 <input type="text"/>	63 <input type="text"/>
	40 <input type="text"/>	48 <input type="text"/>	56 <input type="text"/>	64 <input type="text"/>

1*09

87 <input type="text"/>	Voice Module
88 <input type="text"/>	2nd RCVR
89 <input type="text"/>	2nd RCVR
90 <input type="text"/>	1st RCVR
91 <input type="text"/>	1st RCVR
0 0	
98 <input type="text"/>	Bell Supervision

SYSTEM LAYOUT WORKSHEETS

As with any security system, you should first define the installation. This includes determining how many partitions will be used, how many zones per partition, and how many users per partition. You will also need to determine what peripheral devices will be needed, and basic system options such as exit/entry delays, etc. The control panel itself should be located in an area that will facilitate wire runs to all partitions, and will allow access to power and telephone circuits.

To help you layout a partitioned system, use the following worksheet. This will further simplify the programming process.

PARTITIONS					
Partition #	# of Users (69 max.*)	Descriptor (4 char max)	Prim. Sub. #	Sec. Sub. #	Alpha Default Message (32 character maximum)
Partition 1					
Partition 2					
Keyswitch Arming Partition Assignment (1-2):					
Wireless Keypad Partition Assignment (1-2):					
Use Partition Descriptor (yes/no)?					

* At least one user is assigned per partition, regardless of whether or not that partition is actually used. A maximum of 70 user codes can be programmed in the system.

COMMUNICATION OPTIONS BY PARTITION (enter yes/no)		
Option	part 1	part. 2
Swinger Suppression Count 00-15; 00=no suppression		
Cancel Report After Disarm		
Dialer Reports for Panic (A or * + 1)		
Dialer Reports for Panic (C or # + 3)		
Dialer Reports for Panic (B or * + #)		
Dialer Reports for Duress		
Burglary Alarm Communications Delay (16 sec.)		

SYSTEM DEFINITIONS BY PARTITION (enter values or yes/no)		
Option	part 1	part. 2
Entry Delay #1 (15-225 seconds):		
Exit Delay #1 (15-225 seconds):		
Entry Delay #2 (15-225 seconds):		
Exit Delay #2 (15-225 seconds):		
Quick Arming		
Multiple Alarms per Arming		
Keypad Panic for zone 95 (A or * + 1)		
Keypad Panic for zone 96 (C or # + 3)		
Keypad Panic for zone 99 (B or * + #)		
Allow Sign-on (GOTO function)		
Non-Bypassable Zone (can be any zone 1-64)		
Sounder Timeout Duration (2 min. increments)		
Keypad Annunciation During Entry**		
Keypad Annunciation During Exit		
Confirmation of Arming (ding)		
Chime on External Siren		
Access Control Relay (field 1*76)		

**no= 3 beeps yes=continuous

ZONE DEFINITIONS FOR ZONES 1-24

Zone No.	Zone Type	Parti- tion (1-2)	RF Trans. Type †			Ser. RPM† typ 6	DIP	DIP	Hard Wired typ 1	Report Code	<div style="border: 1px solid black; padding: 2px; display: inline-block; font-size: small;">† Enter loop number on module</div> Loop number must be "1" for hardwire and DIP devices) Zone Information (part numbers) & Alpha Descriptor (3 words max.)
			RF typ 3	UR typ 4	BR typ 5		RPM left lp typ 7	RPM right lp typ 8			
1											
2											
3											
4											
5											
6											
7											
8											
9											
10											
11											
12											
13											
14											
15											
16											
17											
18											
19											
20											
21											
22											
23											
24											

ZONE DEFINITIONS FOR ZONES 25-48

Zone No.	Zone Type	Parti- tion (1-2)	RF Trans. Type†			Ser. RPM† typ 6	DIP	DIP	Hard Wired typ 1	Report Code	<div style="border: 1px solid black; padding: 2px; display: inline-block;">† Enter loop number on module</div> Loop number must be "1" for hardwire and DIP devices) Zone Information (part numbers) & Alpha Descriptor (3 words max.)
			RF typ 3	UR typ 4	BR typ 5		RPM left lp typ 7	RPM right lp typ 8			
25											
26											
27											
28											
29											
30											
31											
32											
33											
34											
35											
36											
37											
38											
39											
40											
41											
42											
43											
44											
45											
46											
47											
48											

ZONE DEFINITIONS FOR ZONES 49-64

Zone No.	Zone Type	Parti- tion (1-2)	RF Trans. Type†			Ser. RPM† typ 6	DIP	DIP	Hard Wired typ 1	Report Code	† Enter loop number on module Loop number must be 1 for hardwire and DIP devices) Zone Information (part numbers) & Alpha Descriptor (3 words max.)
			RF typ 3	UR typ 4	BR typ 5		RPM left lp typ 7	RPM right lp typ 8			
49											
50											
51											
52											
53											
54											
55											
56											
57											
58											
59											
60											
61											
62											
63											
64											

Zone Types: 00=zone not used 05=day/night burglary 10=interior (delay)
 01=entry/exit 1 06=24 hour silent 20=arm stay
 02=entry/exit 2 07=24 hour audible 21=arm away
 03=perimeter 08=24 hour auxiliary 22=disarm
 04=interior (follower) 09=supervised fire 23=no alarm response

REPORTS TO CENTRAL STATION		
Option	No (✓)	Yes (✓)
Armed Stay		
Time/Date Reset		

EVENT LOG TYPES		
Option	No (✓)	Yes (✓)
Alarm		
Trouble		
Bypass		
Open/Close		
System		

ALPHA VOCABULARY

(For Entering Alpha Descriptors. To select a word, press [#] followed by the word's 3-digit number.)

Bulleted words in **bold face type** are those that are also available for use by the 4285 phone module. If using a phone module, and words other than these are selected for alpha descriptors, the phone module will not provide annunciation of those words.

NOTE: This vocabulary is not to be used for relay voice descriptors.

See the vocabulary listed in the RELAY VOICE DESCRIPTORS section when programming relay voice descriptors.

000 (Word Space) • 001 AIR • 002 ALARM 003 ALCOVE 004 ALLEY 005 AMBUSH • 006 AREA • 007 APARTMENT 008 ART • 009 ATTIC 010 AUDIO 011 AUXILIARY • 012 BABY • 013 BACK • 014 BAR 015 BARN • 016 BASEMENT • 017 BATHROOM • 018 BED • 019 BEDROOM 020 BELL • 021 BLOWER • 022 BOILER 023 BOTTOM 024 BOX 025 BREAK • 026 BUILDING 027 BURNER 028 CABINET • 029 CALL 030 CAMERA 031 CAR 032 CASE 033 CASH 034 CCTV 035 CEILING 036 CELLAR • 037 CENTRAL 038 CIRCUIT 039 CLIP • 040 CLOSED 041 COIN 042 COLD 043 COATROOM 044 COLLECTION 045 COMBUSTION • 046 COMPUTER 047 CONTACT • 048 DAUGHTERS 049 DELAYED • 050 DEN	051 DESK • 052 DETECTOR • 053 DINING 054 DISCRIMINATOR 055 DISPLAY 056 DOCK • 057 DOOR 058 DORMER • 059 DOWN • 060 DOWNSTAIRS 061 DRAWER • 062 DRIVEWAY 063 DRUG • 064 DUCT • 065 EAST 066 ELECTRIC 067 EMERGENCY 068 ENTRY • 069 EQUIPMENT 070 EXECUTIVE • 071 EXIT 072 EXTERIOR • 073 FACTORY 074 FAILURE 075 FAMILY • 076 FATHERS • 077 FENCE 078 FILE • 079 FIRE • 080 FLOOR 081 FLOW 082 FOIL • 083 FOYER 084 FREEZER • 085 FRONT 086 FUR 087 FURNACE 088 GALLERY • 089 GARAGE • 090 GAS 091 GATE • 092 GLASS 093 GUEST 094 GUN • 095 HALL • 096 HEAT 097 HIGH 098 HOLDUP 099 HOUSE 100 INFRARED	• 101 INSIDE 102 INTERIOR 103 INTRUSION 104 JEWELRY • 105 KITCHEN • 106 LAUNDRY • 107 LEFT 108 LEVEL • 109 LIBRARY • 110 LIGHT 111 LINE 112 LIQUOR • 113 LIVING • 114 LOADING 115 LOCK 116 LOOP 117 LOW • 118 LOWER • 119 MACHINE 120 MAGNETIC 121 MAIDS 122 MAIN • 123 MASTER 124 MAT • 125 MEDICAL 126 MEDICINE 127 MICROWAVE 128 MONEY 129 MONITOR • 130 MOTHERS • 131 MOTION 132 MOTOR 133 MUD • 134 NORTH 135 NURSERY • 136 OFFICE 137 OIL • 138 OPEN 139 OPENING • 140 OUTSIDE 141 OVERFLOW 142 OVERHEAD 143 PAINTING • 144 PANIC 145 PASSIVE • 146 PATIO 147 PERIMETER • 148 PHONE 149 PHOTO 150 POINT	151 POLICE 152 POOL • 153 POWER 154 QUAD 155 RADIO • 156 REAR 157 RECREATION 158 REFRIG 159 REFRIGERATION 160 RF • 161 RIGHT • 162 ROOM 163 ROOF 164 SAFE 165 SCREEN 166 SENSOR • 167 SERVICE • 168 SHED 169 SHOCK • 170 SHOP 171 SHORT 172 SHOW • 173 SIDE 174 SKYLIGHT 175 SLIDING • 176 SMOKE 177 SONIC • 178 SONS • 179 SOUTH 180 SPRINKLER 181 STAMP • 182 STATION 183 STEREO 184 STORE • 185 STORAGE 186 STORY 187 STRESS 188 STRIKE 189 SUMP 190 SUPERVISED 191 SUPERVISION 192 SWIMMING 193 SWITCH 194 TAMPER 195 TAPE 196 TELCO 197 TELEPHONE 198 TELLER • 199 TEMPERATURE 200 THERMOSTAT • 201 TOOL	202 TRANSMITTER 203 TRAP 204 ULTRA • 205 UP • 206 UPPER • 207 UPSTAIRS • 208 UTILITY 209 VALVE 210 VAULT 211 VIBRATION 212 VOLTAGE 213 WALL 214 WAREHOUSE 215 WASH • 216 WEST • 217 WINDOW 218 WINE • 219 WING 220 WIRELESS 221 WORK 222 XMITTER 223 YARD 224 ZONE (No.) • 225 ZONE • 226 0 • 227 1 • 228 1ST • 229 2 • 230 2ND • 231 3 • 232 3RD • 233 4 • 234 4TH • 235 5 • 236 5TH • 237 6 • 238 6TH • 239 7 • 240 7TH • 241 8 • 242 8TH • 243 9 • 244 9TH 250 Custom Word 1 to 269 Custom Word 20
---	--	---	--	---

*Note: This factory-provided vocabulary of words is subject to change.

CHARACTER (ASCII) CHART (For Adding Custom Words)

32 (space)	42 *	51 3	61 =	71 G	81 Q
33 !	43 +	52 4	62 >	72 H	82 R
34 "	44 ,	53 5	63 ?	73 I	83 S
35 #	45 -	54 6	64 @	74 J	84 T
36 \$	46 .	55 7	65 A	75 K	85 U
37 %	47 /	56 8	66 B	76 L	86 V
38 &	48 0	57 9	67 C	77 M	87 W
39 '	49 1	58 :	68 D	78 N	88 X
40 (50 2	59 ;	69 E	79 O	89 Y
41)		60 <	70 F	80 P	90 Z

5800 Series Transmitter Input Loop Identification

- All of the transmitters illustrated below have one or more unique factory assigned input (loop) ID codes. *Each of the inputs requires its own programming zone* (e.g., a 5803's three inputs require three programming zones).
- Transmitter inputs entered as:

"RF" (Supervised RF) Type send periodic check-in signals, as well as fault, restore and low battery signals. The transmitter must remain within the receiver's range.

"UR" (Unsupervised RF) Type send all the signals that the "RF" Type does, but the control does not supervise the check-in signals. The transmitter may, therefore, be carried off-premises.

"BR" (Unsupervised Button RF) Type only send fault signals. They do not send restore, check-in, or automatic low battery signals. The transmitter may be carried off-premises.

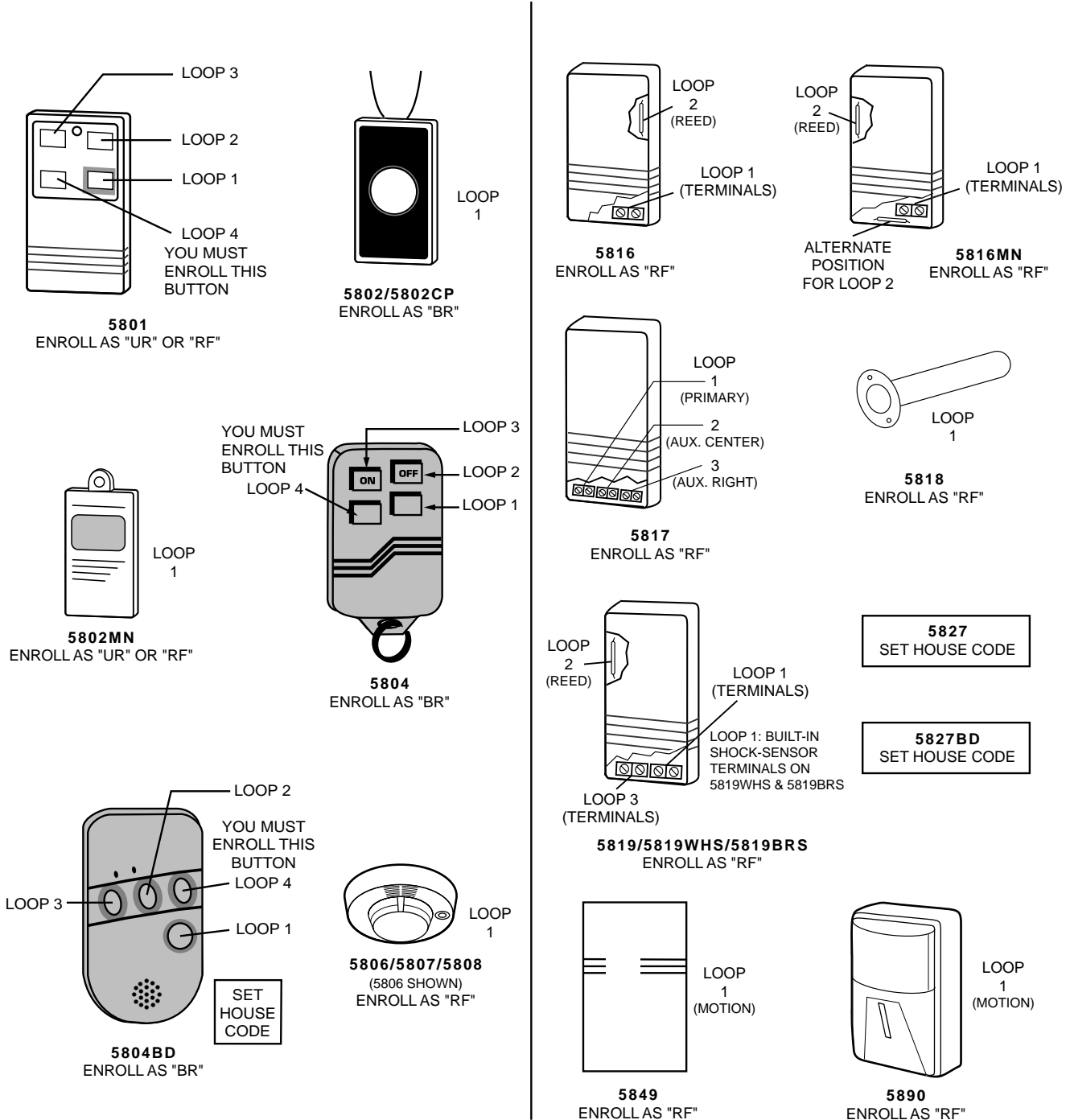

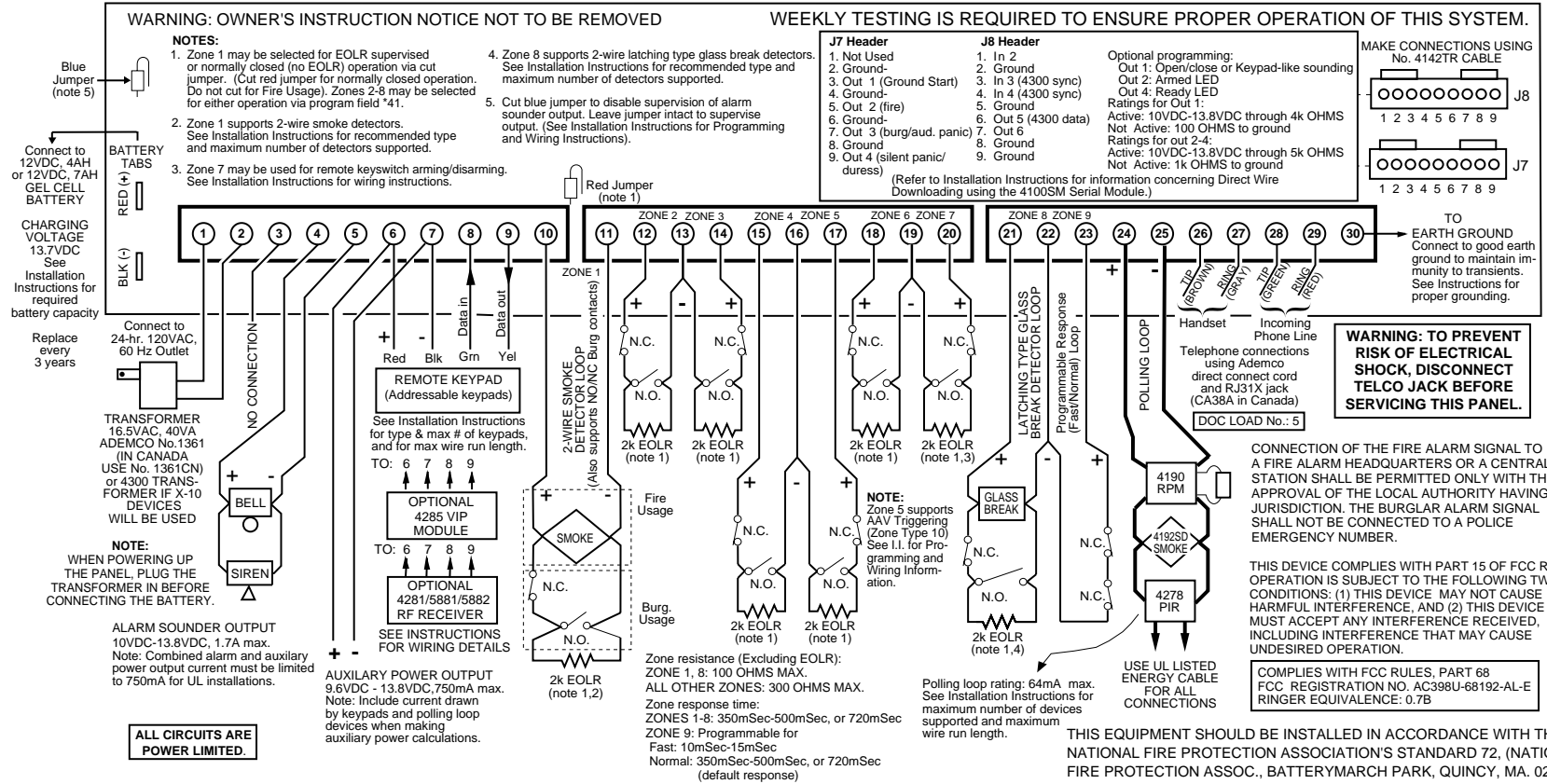

VISTA-40 SUMMARY OF CONNECTIONS

THIS EQUIPMENT SHOULD BE INSTALLED IN ACCORDANCE WITH THE NATIONAL FIRE PROTECTION ASSOCIATION'S STANDARD 72, (NATIONAL FIRE PROTECTION ASSOC., BATTERYMARCH PARK, QUINCY, MA. 02269). PRINTED INFORMATION DESCRIBING PROPER INSTALLATION, OPERATION, TESTING, MAINTENANCE, EVACUATION PLANNING AND REPAIR SERVICE IS TO BE PROVIDED WITH THIS EQUIPMENT.

ADEMCO
GROUP

165 Eileen Way, Syosset, New York 11791
Copyright © 1997 PITTWAY CORPORATION



N7001PRV4 7/98